

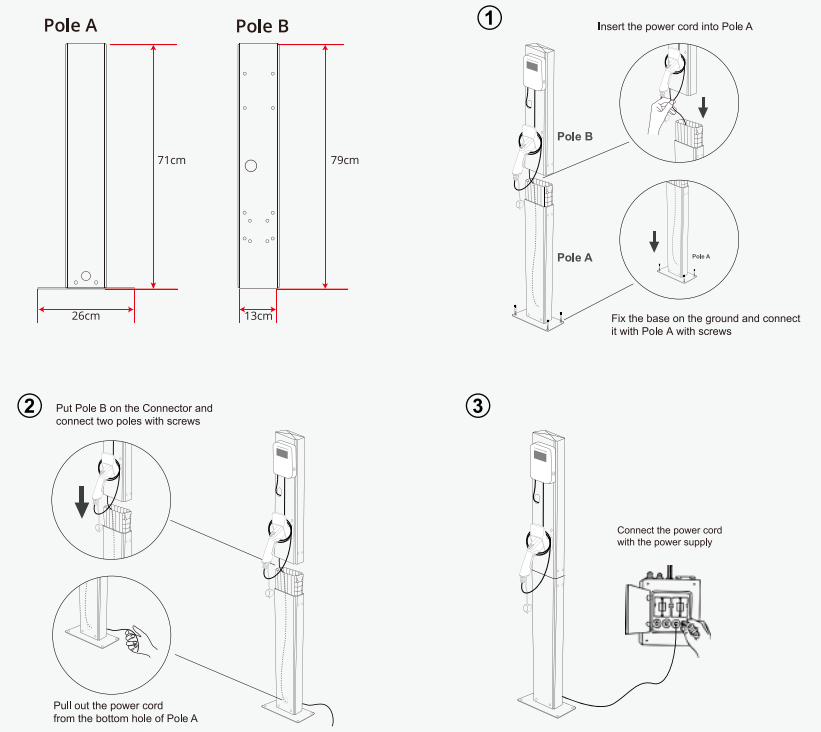

PRODUCT ADVANTAGES

- One-side or two-side punching available
- Cable management available
- Durability for all weather conditions
- Lighter and smaller package with less transportation cost

Quick installation



Installation pole BS-IT002

| | |
|---------------|-------------------|
| Width | 13cm |
| Height | 150cm |
| Base | 26cm*14.5cm |
| Material | Aluminum material |
| Weight | 6.6kg |
| Pole A | |
| Width | 13cm |
| Height | 71cm |
| Pole B | |
| Width | 13cm |
| Height | 79cm |